

**CONTENTS**

- A. 1 Base with LED light
- B. 1 Beaker
- C. 3 Nail Polish Holders
- D. 1 Stir Stick
- E. 4 Pipettes
- F. 3 Nail Disks
- G. 1 Nail Adhesive Sheet

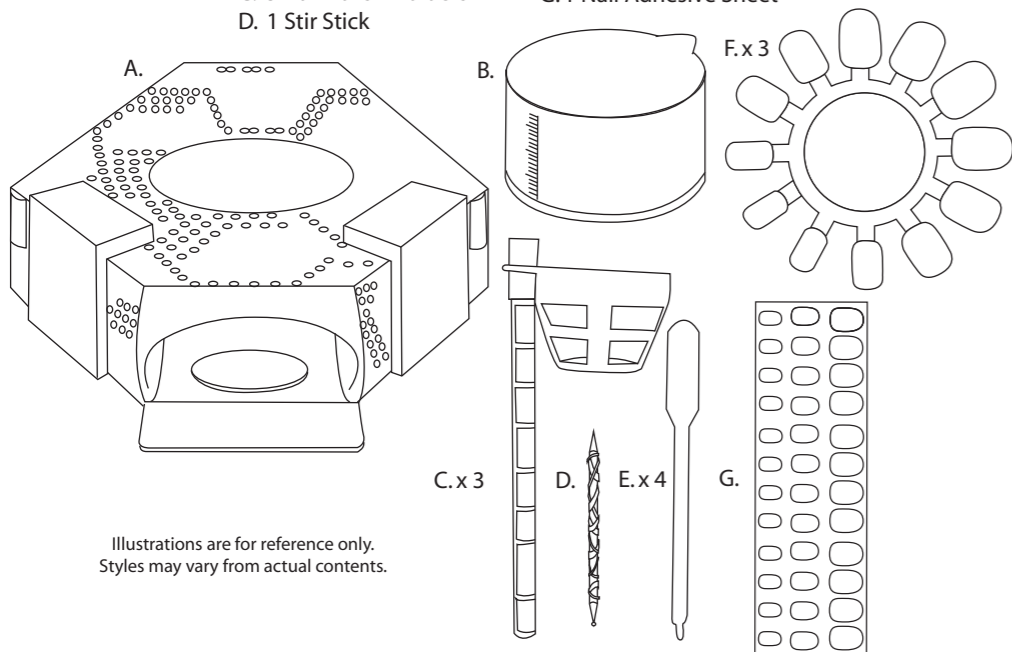

Illustrations are for reference only.  
Styles may vary from actual contents.

**YOUR HOUSEHOLD ITEMS**

(Not Included)

Ask an adult to help you gather all the household items needed and supervise during the experiment.

- H. 2 or more Nail Polishes
- I. Tape
- J. Water
- K. Nail Polish Remover
- L. Cotton Swabs

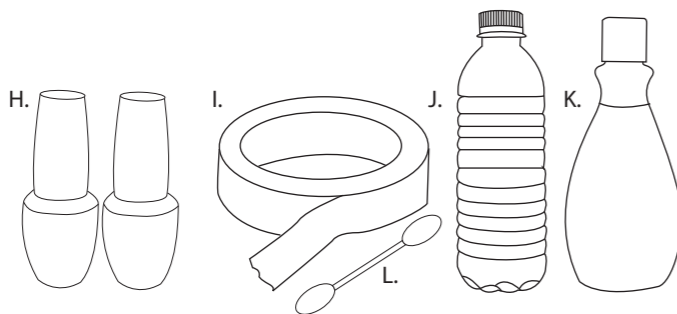

**BATTERY INSTALLATION**

Before playing, an adult must install fresh alkaline batteries in the nail base. Here's how:

1. Using a Phillips screwdriver (not included) remove the screw and battery compartment cover from under the nail base.
2. Install three (3) fresh 1.5V AA (LR6) alkaline batteries (not included) making sure the (+) and (-) ends face the proper direction as indicated inside the battery compartment.
3. Replace the compartment cover and tighten the screw.

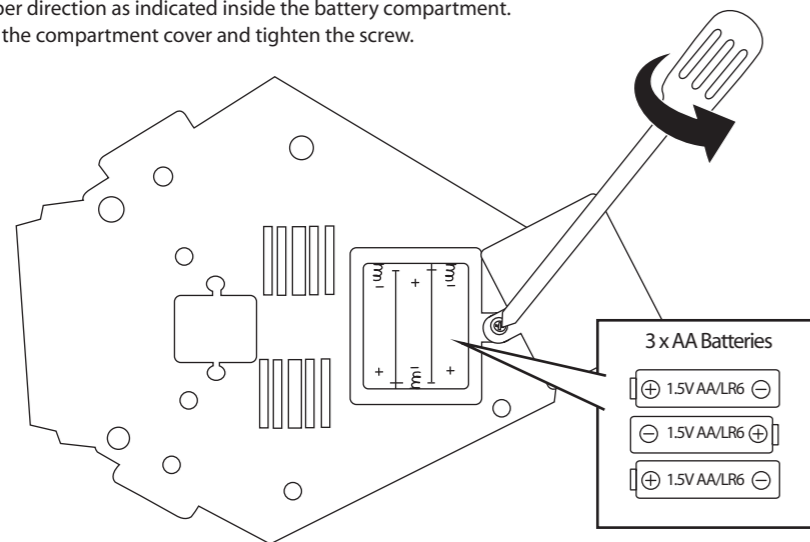

**GETTING STARTED**

NOTE: Before beginning, cover the play area to avoid possible damage.

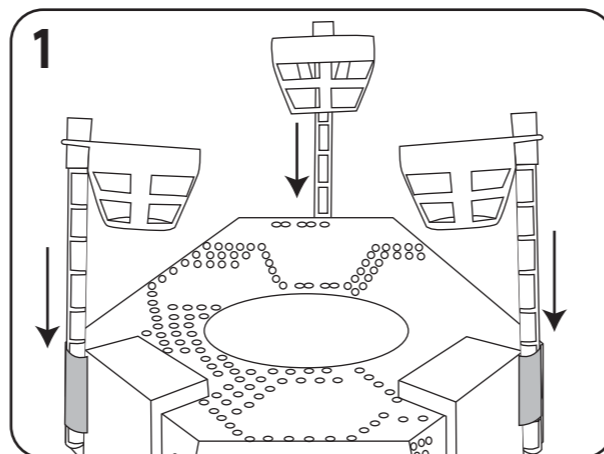

1 Insert the three nail polish holders into the openings on the base.

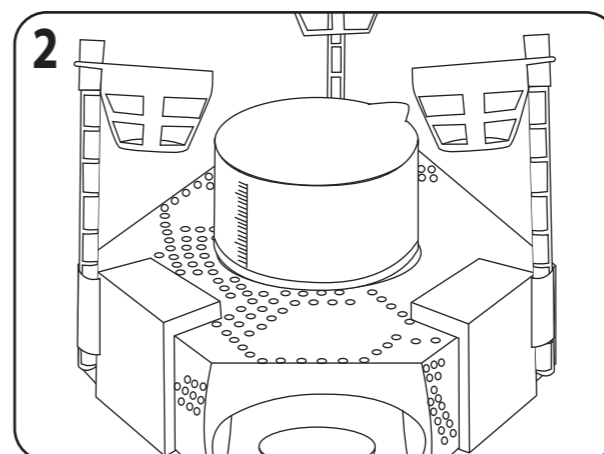

2 Place the beaker in the center of the base.

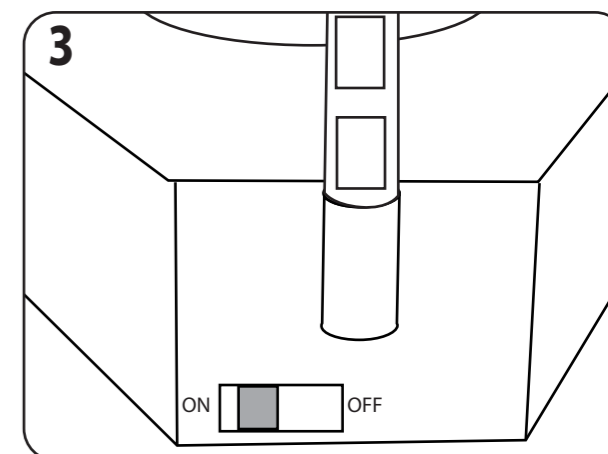

3 Move the switch on the back of the base to the ON position. The base will light up.

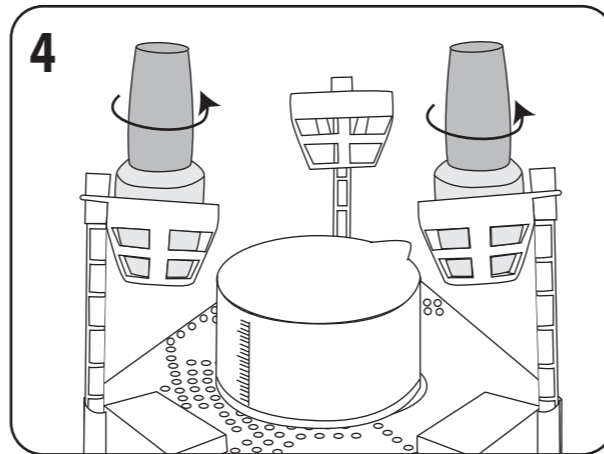

4 Shake all nail polishes. With the baskets facing inward, place a nail polish in each holder and twist open the nail polish caps.

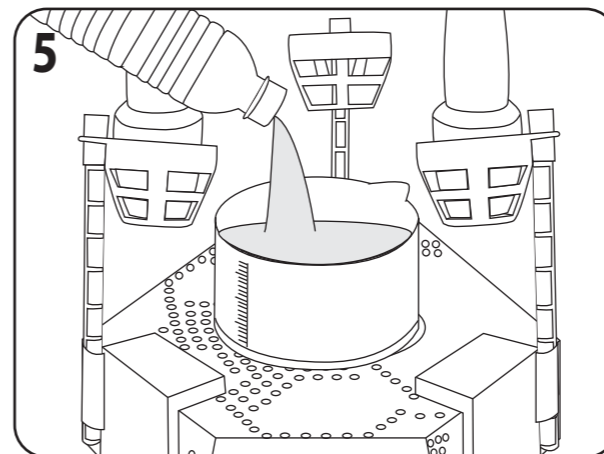

5 Fill the beaker 3/4 full of water.

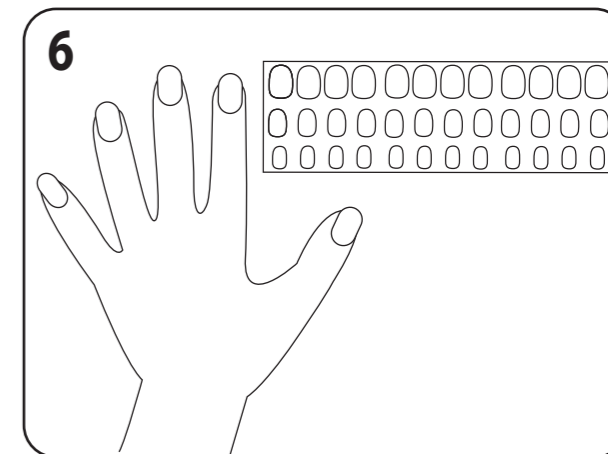

6 Select the appropriate size adhesive for each nail. Peel off the adhesives and apply to your nails. Then, peel off the top layer.

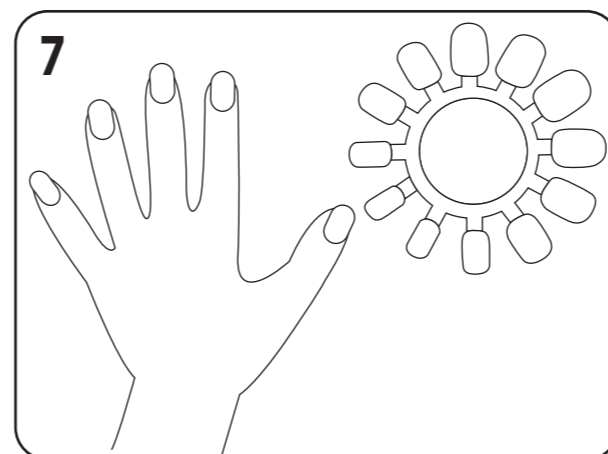

7 Pull off the appropriate size nail and stick it on top of the nail adhesive.

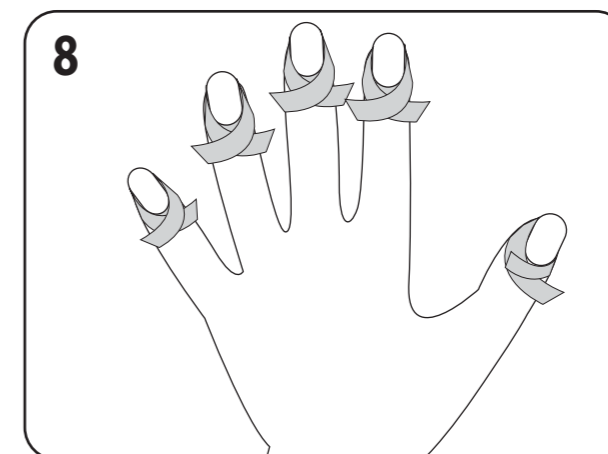

8 Mask off the area around your nails with tape. **IMPORTANT** : Only the nails should be exposed. Thoroughly cover fingertips.

## DESIGNING

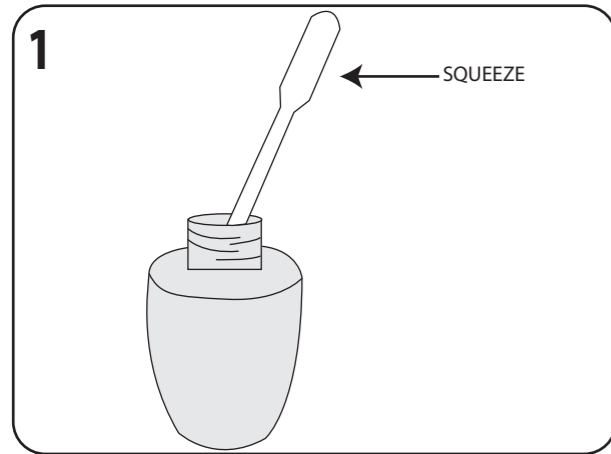

1 Insert a pipette into one nail polish. Gently squeeze the top and release to gather nail polish.

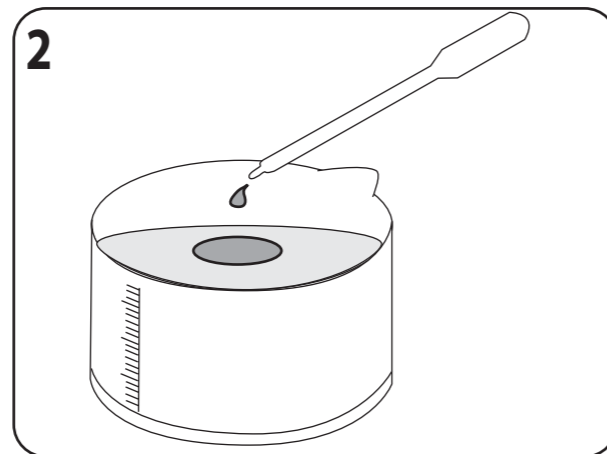

2 Hold the pipette over the beaker and squeeze to release one drop of nail polish.

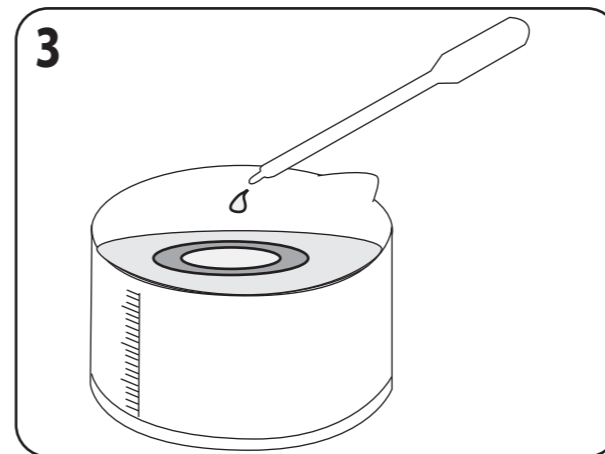

3 Use another pipette to quickly drop in one drop of another color into the center of the first color.

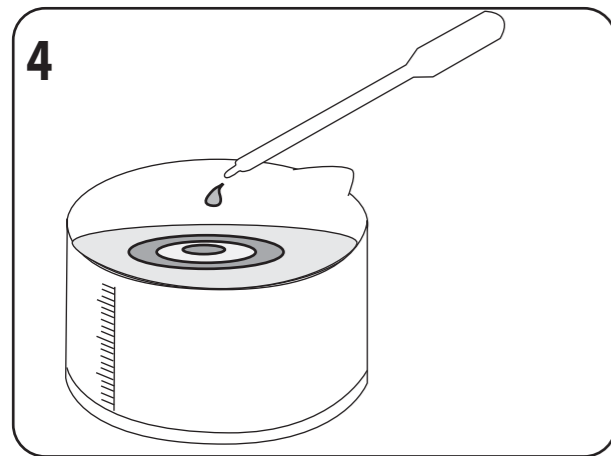

4 Use the first pipette to quickly drop in one more drop of the first color into the center of the second color. It should look like a bull's-eye.

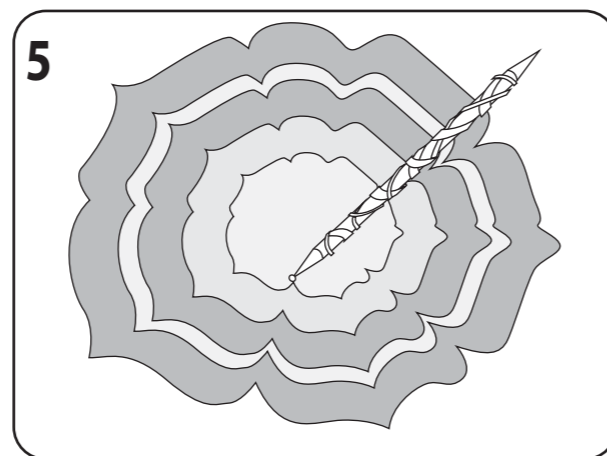

5 Use the stir stick to blend the colors and create unique patterns.  
NOTE: If the colors won't blend, empty the beaker and start again. Make sure to drop nail polish into the water as quickly as possible.

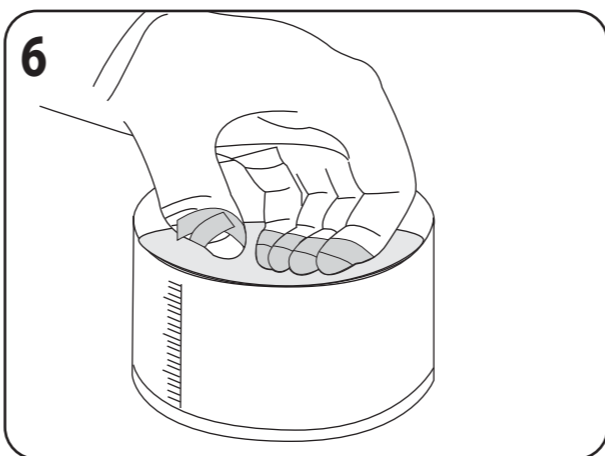

6 Dip your fingers into the water with your nails facing downward over the design.

**TIP:** Dip one nail at a time for different designs! To do this, empty the beaker and start again before each nail.



7 Use the stir stick to remove excess polish from the water around your nails. Then, pull your nails out of the water and shake off excess water.

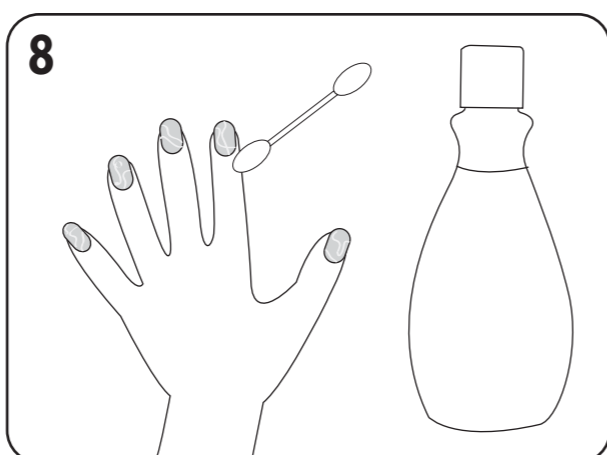

8 Remove the tape around the nails. Remove excess polish on your fingers with nail polish remover. Empty the beaker and start again for the other hand.

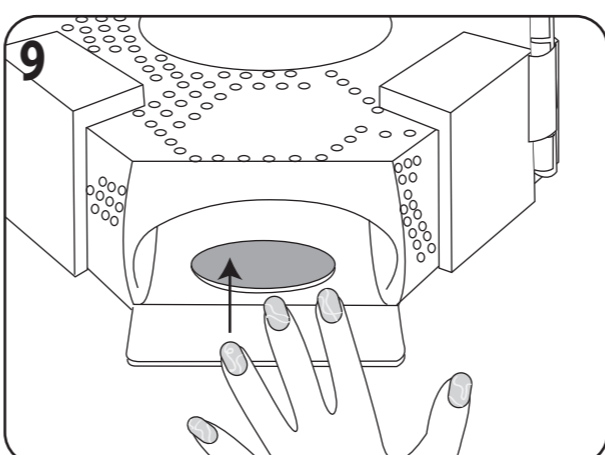

9 Place your fingers in the nail dryer on the base. Press and hold the center button to turn on the fan and dry your nails.

## IMPORTANT INFORMATION

⚠ CAUTION: Stir stick contains a functional sharp point. Keep away from small children.

- Use adult nail polish only. Nail polish intended for children may not work for this experiment.
- Clean the pipettes, stir stick and beaker with acetone to remove any nail polish after designing.
- To clean the pipettes, dip them in acetone and squeeze to gather product. Let the acetone soak for 30 seconds and then squeeze to empty. Repeat this process until nail polish is gone. Then, rinse with water.
- Always turn the unit off after use to conserve battery power.
- Nail polish will dry quickly in water. Work as fast as possible for best results.
- Do not use adhesives on anything other than your nails, as they may not be removed from certain fabrics or surfaces.
- To remove plastic nails, gently peel of the nail and adhesive.
- Nail adhesives are not reusable. Discard after use.
- Keep nail polish, nail polish remover and acetone away from fire.

## SAFE BATTERY USAGE

- Use alkaline batteries for best performance and longer life.
- Use only the type battery recommended for the unit.
- Batteries should be replaced only by an adult.
- Insert batteries with the correct polarity (+ and -).
- Do not mix old and new batteries.
- Do not mix alkaline, standard (carbon-zinc), or rechargeable (nickel-cadmium) batteries.
- Do not short-circuit batteries.
- When not used for an extended time, remove batteries to prevent possible leakage and damage to the unit.
- Do not mix rechargeable and non-rechargeable batteries.
- Rechargeable batteries are to be removed from the toy before charging.
- Rechargeable batteries are to be recharged only under adult supervision.
- Do not recharge non-rechargeable batteries.
- Exhausted batteries are to be removed from the toy.
- Do not dispose of batteries in fire as they may leak or explode.

## FCC COMPLIANCE

NOTE: This equipment has been tested and found to comply with the limits for a Class B digital device, pursuant to Part 15 of the FCC Rules. These limits are designed to provide reasonable protection against harmful interference in a residential installation. This equipment generates, uses and can radiate radio frequency energy and, if not installed and used in accordance with the instructions, may cause harmful interference to radio communications. However, there is no guarantee that interference will not occur in a particular installation. If this equipment does cause harmful interference to radio or television reception, which can be determined by turning the equipment off and on, the user is encouraged to try to correct the interference by one or more of the following measures:

- Reorient or relocate the receiving antenna.
- Increase the separation between the equipment and receiver.
- Connect the equipment into an outlet on a circuit different from that to which the receiver is connected.
- Consult the dealer or an experienced radio/TV technician for help.

This device complies with Part 15 of the FCC Rules. Operation is subject to the following two conditions: (1) This device may not cause harmful interference, and (2) this device must accept any interference received, including interference that may cause undesired operation.

Warning: Changes or modifications to this unit not expressly approved by the party responsible for compliance could void the user's authority to operate the equipment.

♻ Let's care for the environment!  
The wheelie bin symbol indicates that the product must not be disposed of with other household waste. Please use designated collection points or recycling facilities when disposing of the item. Do not treat old batteries as household waste. Take them to a designated recycling facility.

Download our free iOS apps:



Follow us:



Watch on:



Kids, ask your parents to download the Project Mc2™ apps, available on iOS devices through the app store:

- Click on the App Store icon on your iOS device.
- Click "Search" on your mobile device and type in "Project Mc2"
- Once the correct app names come up on the screen, tap on the word "get."
- You may be asked for your Apple ID. If so, enter your ID or follow the instructions on screen to get one.
- Once your ID is accepted, watch the download status until the downloads are complete.
- The application icons should appear on your device. Tap the icon to activate the apps.

The Project Mc2™ apps require iOS 6.1 or later. Compatible with iPod Touch® 4, iPhone® 4 and iPad® 2 or later versions. Data rates may apply.

Please keep this manual as it contains important information.



0916-0-E/INT

www.projectmc2.com  
© 2017 MGA Entertainment, Inc.  
PROJECT MC2™ is a trademark of MGA in the U.S. and other countries. All logos, names, characters, likenesses, images, slogans, and packaging appearance are the property of MGA.  
16300 Roscoe Blvd.  
Van Nuys, CA 91406 U.S.A.  
(800) 222-4685  
Printed in China

MGA Entertainment UK Ltd.  
50 Presley Way  
Crownhill  
Milton Keynes, MK8 0ES  
Bucks, UK  
+ 0800 521 558

The preferred method of contact for Customer Service is through our e-mail contact form at [www.mgae.com](http://www.mgae.com)

