

! WARNING:

This toy produces flashes that may trigger epilepsy in sensitized individuals.

IMPORTANT INFORMATION

- Not for children under 6 years. Keep out of reach of very young children.
- Adult supervision is required when children are playing with water.
- Contents are not real food. Do not eat.
- Keep slime away from paper surfaces, as it will stick permanently.
- Color transfer from pigments may occur. Wash hands thoroughly after use and keep slime away from clothing and surfaces other than the bottle.
- Keep contents away from eyes, mouth and face.
- Avoid contact with the eyes. Keep away from damaged skin. Use under adult supervision.
- Do not dispose of slime in the drain. Dispose in a trash receptacle once you are finished playing with it.
- Clean the bottle with water. Rinse thoroughly and air dry in a well-ventilated area.
- Slime will dry out over time. Store in a sealed container to prevent drying out when not in use.
- Do not place your hand in the claw machine.
- When refilling, keep the claw away from the opening to prevent damage to the unit.
- Do not overfill the machine. The claw needs room to freely move around.
- When refilling, egg containers must have enough weight to pass through the chute.

SAFE BATTERY USAGE

- Use alkaline batteries for best performance and longer life.
- Use only the battery type recommended for the unit.
- Batteries should be replaced only by an adult.
- Insert batteries with the correct polarity (+ and -).
- Do not mix old and new batteries.
- Do not mix alkaline, standard (carbon-zinc), or rechargeable batteries.
- Do not short-circuit batteries.
- When not used for an extended time, remove batteries to prevent possible leakage and damage to the unit.
- Do not mix rechargeable and non-rechargeable batteries.
- Rechargeable batteries are to be removed from the toy before charging.
- Rechargeable batteries are to be recharged only under adult supervision.
- Do not recharge non-rechargeable batteries.
- Exhausted batteries are to be removed from the toy.
- Do not dispose of batteries in fire as they may leak or explode.



'Let's care for the environment!'

The wheelie bin symbol indicates that the product must not be disposed of with other household waste. Please use designated collection points or recycling facilities when disposing of the item. Do not treat old batteries as household waste. Take them to a designated recycling facility.

FCC COMPLIANCE

NOTE: This equipment has been tested and found to comply with the limits for a Class B digital device, pursuant to Part 15 of the FCC Rules. These limits are designed to provide reasonable protection against harmful interference in a residential installation. This equipment generates, uses and can radiate radio frequency energy and, if not installed and used in accordance with the instructions, may cause harmful interference to radio communications. However, there is no guarantee that interference will not occur in a particular installation. If this equipment does cause harmful interference to radio or television reception, which can be determined by turning the equipment off and on, the user is encouraged to try to correct the interference by one or more of the following measures:

- Reorient or relocate the receiving antenna.
 - Increase the separation between the equipment and receiver.
 - Connect the equipment into an outlet on a circuit different from that to which the receiver is connected.
 - Consult the dealer or an experienced radio/TV technician for help.
- This device complies with Part 15 of the FCC Rules. Operation is subject to the following two conditions: (1) This device may not cause harmful interference, and (2) this device must accept any interference received, including interference that may cause undesired operation.

Caution: Modifications not authorized by the manufacturer may void users authority to operate this device.
CAN ICES-3 (B)/NMB-3(B).



POOPSIE CLAW MACHINE

Ages 6+

! WARNING:
CHOKING HAZARD—Small parts.
Not for children under 3 years.

SKU: 562702

ADULT SUPERVISION REQUIRED

CONTENTS

- A. 1 Claw Machine
- B. 2 Surprise Cutie Tooties™ Characters in Egg Containers
- C. 4 Unicorn Food Packets (Slime Powder) in Egg Containers: (2 per egg)
- D. 1 Bottle
- E. 1 Measuring Cup in Bottle

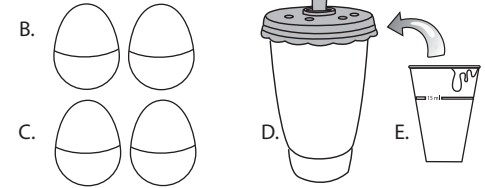
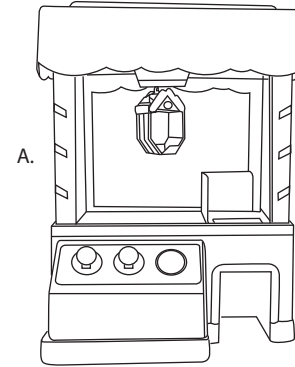

ADULT BATTERY INSTALLATION

Before playing, an adult must install fresh alkaline batteries (not included) in the unit. Here's how:

1. Using a Phillips screwdriver (not included) remove the screw and battery compartment cover from under the claw machine.
2. Install four (4) 1.5V AA (LR6) alkaline batteries (not included) making sure the (+) and (-) ends face the proper direction as indicated inside the battery compartment.
3. Replace the compartment cover and tighten the screw.

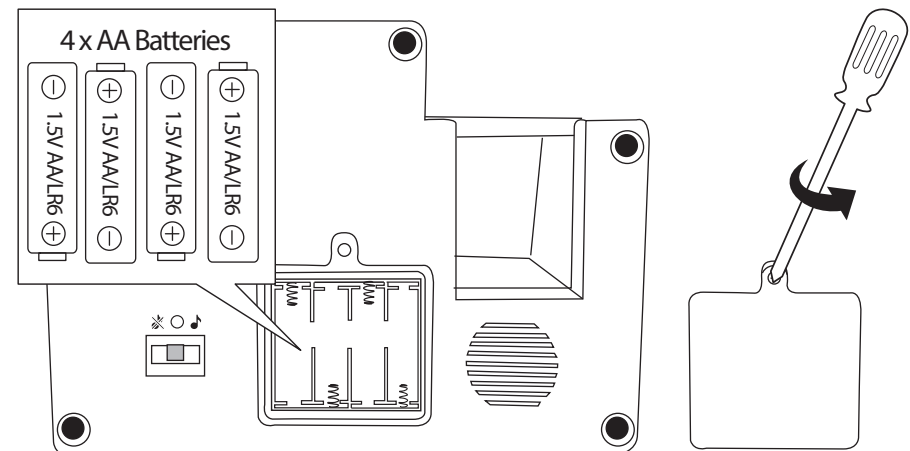

Please keep this manual as it contains important information.



WWW.POOPSIESLIMESURPRISE.COM
©2019 MGA Entertainment, Inc.
POOPSIE™ and POOPSIE SLIME SURPRISE!™ are trademarks of MGA in the U.S. and other countries. All logos, names, characters, likenesses, images, slogans, and packaging appearance are the property of MGA.

The preferred method of contact for Customer Service is through our e-mail contact form at www.mgae.com

0419-0-E

Printed In China

MGA Entertainment, Inc.
16300 Roscoe Blvd. Van Nuys, CA 91406 U.S.A.
(800) 222-4685

QUICK START

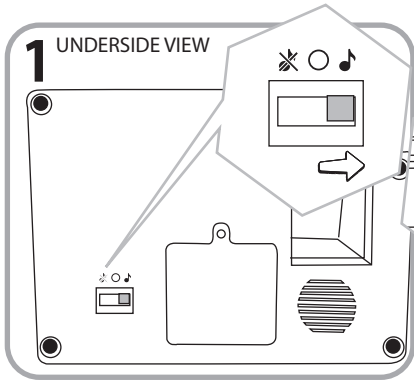

1 **UNDERSIDE VIEW**
Move the switch from the OFF (O) position to the no music mode or music mode.

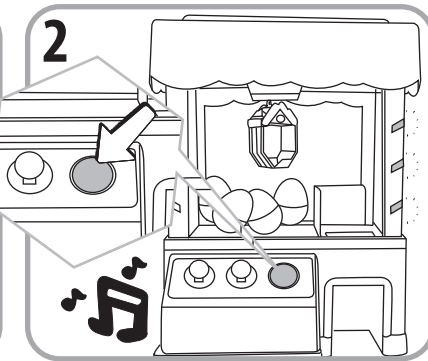

2 Press the button on the front of the machine to start. You have one minute to try to grab a prize with the claw. A song will start playing (in music mode), and the machine will light up.

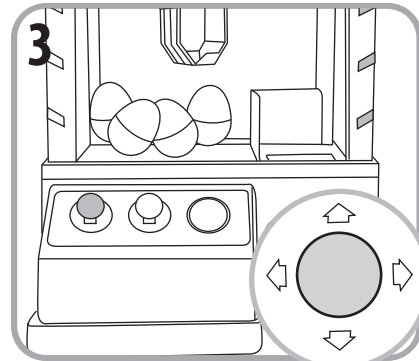

3 Use the left joystick to move the claw left or right, forward or backward.

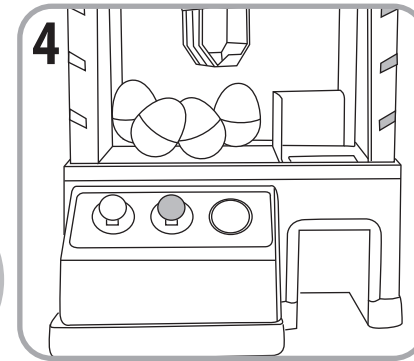

4 Use the right joystick to move the claw up and down. It will open and close as you move it up or down.

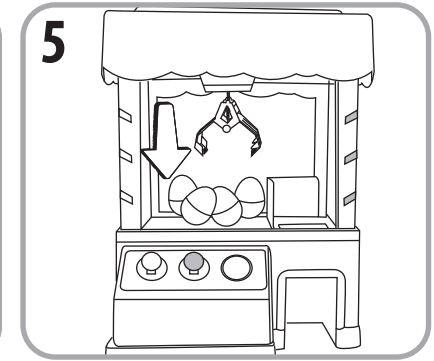

5 Drop the claw down to grab an item.

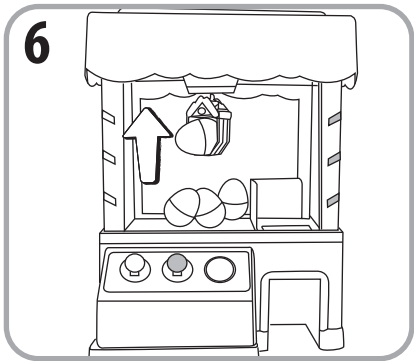

6 Bring the claw up to pick up the item.

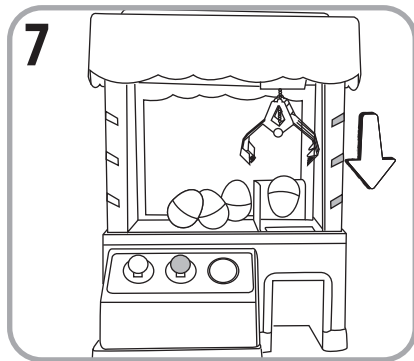

7 Move the claw over the chute, and bring the claw down to release the item into the opening.

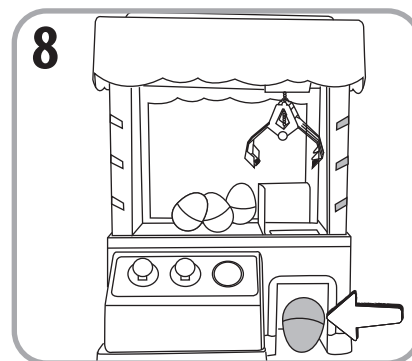

8 Grab your prize!

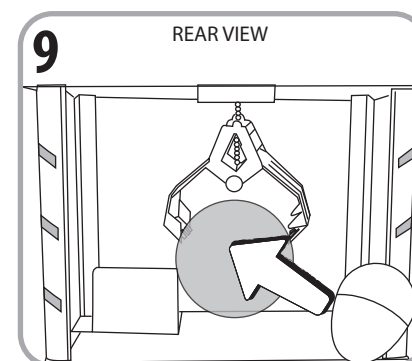

9 **REAR VIEW**
Refill the machine through the opening on the back of the unit. **DO NOT OVERFILL.**

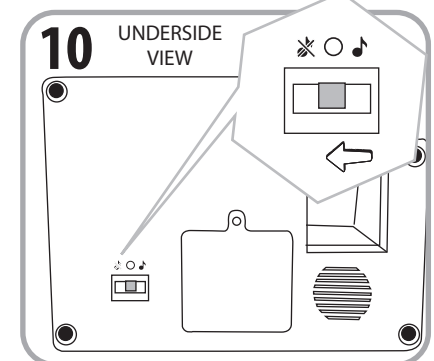

10 **UNDERSIDE VIEW**
Always turn the machine OFF (O) after playing to conserve battery power.

MAKE UNICORN POOP!

Before beginning, cover the play area to prevent possible damage.

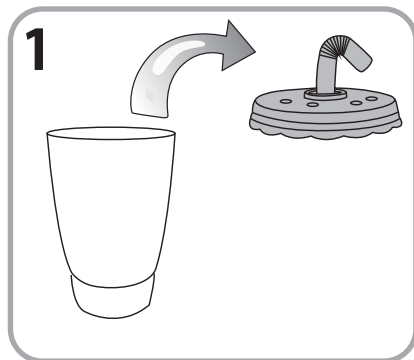

1 Remove the lid from the included bottle.

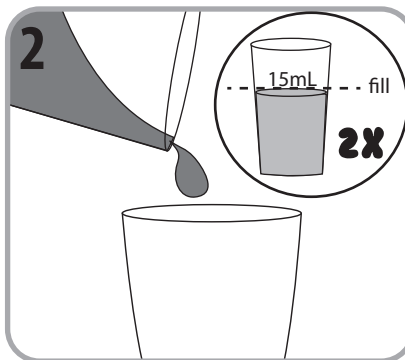

2 Fill the measuring cup to the fill line marked 15 mL with water, and pour it into bottle. Then, fill and repeat once more (total 30mL of water).

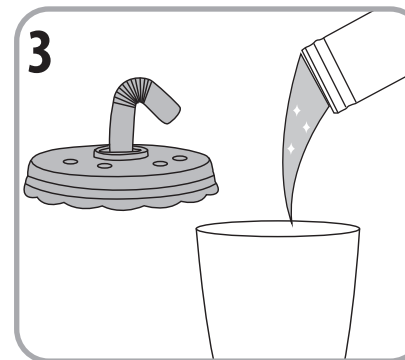

3 Tear open one unicorn food packet and pour the powder into the bottle.

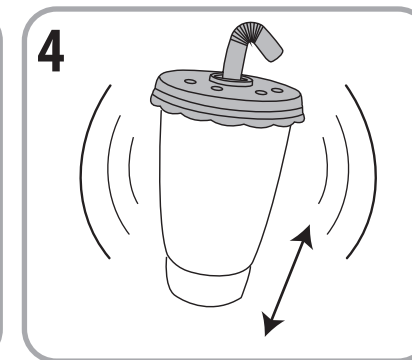

4 Tightly replace the lid on the bottle. Then, hold the lid, and rapidly shake the bottle up and down for 1 minute. Let the mixture sit for 10-15 minutes to allow the slime to harden.



5 Open the lid and remove the slime from the bottle.